

Data Sheet | Item Number: 221-2504

Mounting carrier with strain relief; 4-way; for inline splicing connector with lever; for screw mounting; gray

<https://www.wago.com/221-2504>

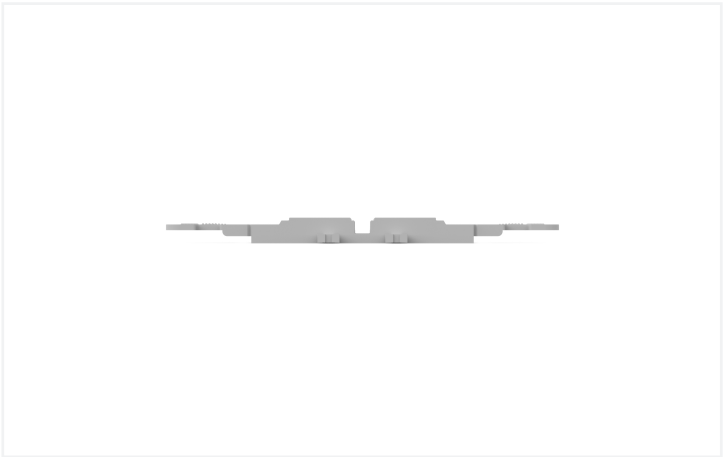

Color: ■ gray

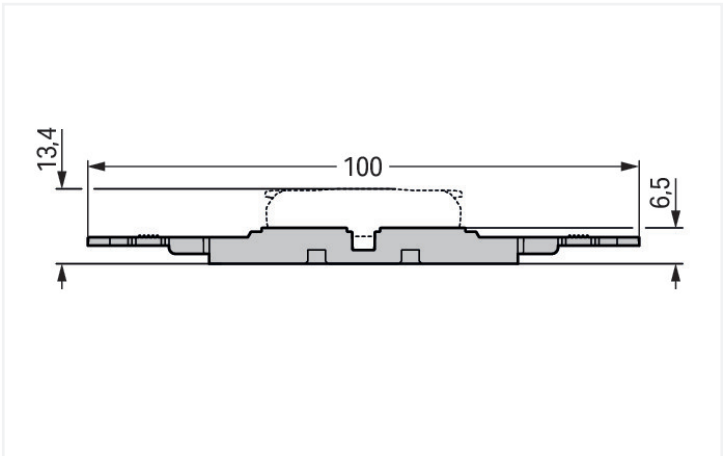
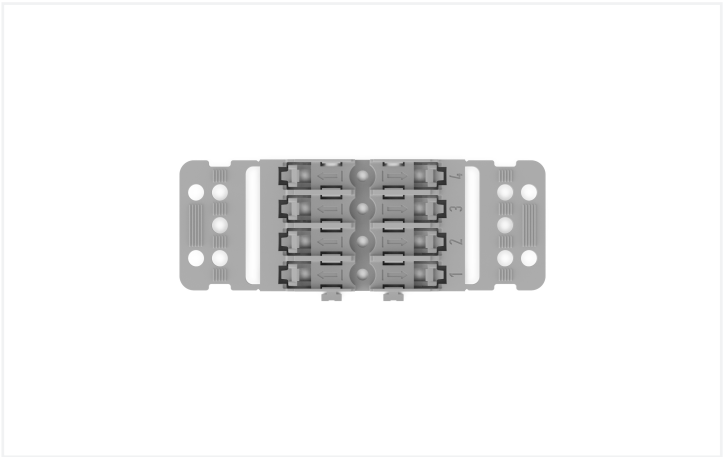

Physical data		
Width		38.8 mm / 1.528 inches
Height from the surface		6.5 mm / 0.256 inches
Depth		100 mm / 3.937 inches

Mechanical data		
Design		4-way
Mounting type		Screw mount

Material data		
Note (material data)		Information on material specifications can be found here
Color		gray
Fire load		0.245 MJ
Weight		8.1 g

Commercial data		
ETIM 9.0		EC002848
ETIM 8.0		EC002848
PU (SPU)		25 (5) pcs
Packaging type		Box
Country of origin		CN
GTIN		4066966119855
Customs tariff number		39269097900

Environmental Product Compliance		
RoHS Compliance Status		Compliant,No Exemption

Downloads

Environmental Product Compliance

Compliance Search

Environmental Product Compliance 221-2504

↓

CAD/CAE-Data

CAD data

2D/3D Models 221-2504

↓

CAE data

EPLAN Data Portal 221-2504

↓

ZUKEN Portal 221-2504

↓

1 Compatible Products

1.1 Optional Accessories

1.1.1 Installation

1.1.1.1 Mounting accessories



Item No.: 209-119
Fixing screw; for 209-120 mounting carrier



Item No.: 209-123
Mounting foot with screw; can be screwed on terminal blocks with fixing flange; 6.4 mm wide; gray



Item No.: 209-120
Mounting foot; can be snapped on terminal blocks with snap-in mounting foot; for mounting on relay-modules; 6.4 mm wide; gray

1.1.2 Marking

1.1.2.1 Marking strip



Item No.: 210-834
Marking strips; on reel; 5 mm wide; plain; Self-adhesive; white

Installation Notes

Installation

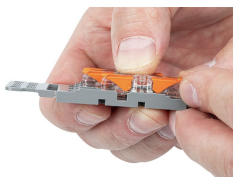

Place the inline splicing connector on the carrier in front of the mounting position.

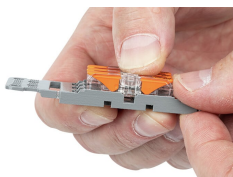

Push the connector to the center position until it snaps into place.



Mounting carrier without strain relief – snapped onto DIN-rail



Various combinations of 1- to 5-connector mounting carriers are possible via side-by-side latching mechanism.

Strain relief

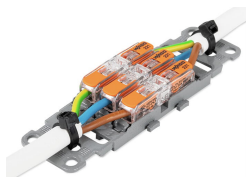

3-pole mounting carrier with strain relief

